

Tecele Polipasto Prowinch c/carro electrico Monoviga 5 Tons trifasico



Características Esenciales

- Equipo de Doble Velocidad, Mono viga. Servicio Heavy Duty H4/M5.
- Dispositivos de Límite de alta precisión, Protección de Sobrecarga y Protección térmica
- Componentes de alta calidad, Motor SEW Eurodrive, VDF Schneider, contactores Eaton/Schneider
- Estándares US y EC ASME HST-1 , ASME B30.16 , ASME B30.17 , EN14492-2 , EN60204-32.
- 3 Años de Garantía, Partes y Servicios Disponibles en América

Especificaciones Técnicas

Capacidad de Carga	11023 lb / 5000 kg	Voltaje del Control	48V
Altura de Izaje Estandar (Customizable)	40 ft / 12 m	Motor de Izaje	Sew Eurodrive
Velocidad /min	2.62 - 16.4 ft/min / 0.8 - 5 m /min	Reductor de Izaje	Sew Eurodrive FA
Numero de Velocidades	2 Speed	Hoist Contactor Brand	Schneider or EATON
Voltaje	3 Phase 208~240/440~480V 50/60Hz	Tipo Transmisión / Reductor	Sew Eurodrive
Potencia Total Watts	1.0 - 6.1 kW	Humedad	<85%
Clase de Servicio	H4/M5/2m/Class D	Temperatura	-4°~104° F / -20°~40° C
Tipo de Motor	Squirrel Cage Induction Motor	Potencia del Trolley	0.37 ~ 0.64 kW
Freno Motor	Electromagnetic Release Brake >125%	Nivel de Ruido	82 dB
Grado de Aislacion	F	Velocidad del Trolley /min	16 ~ 65 ft/min. / 5 ~ 20 m/min
Protección IEC Motor	IP55	Rango de ancho de la Viga	7.9~13.7 in / 200~350 mm
Protección Tablero de Control	IP65	Normas	ASME HST-4 , ASME B30.16 , B30.17 , EN14492-2 , EN60204-32
Control	Pendant Control and Optional Wireless F21	Garantía	3 Year

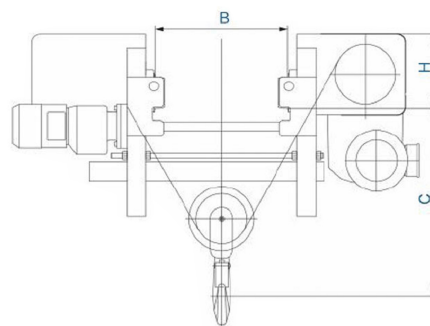
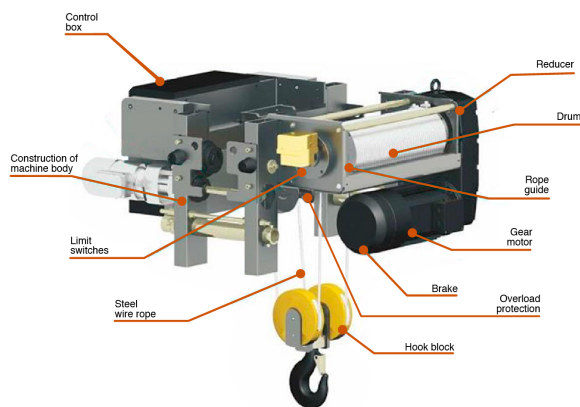

DRIVE TECHNOLOGY
SEW Eurodrive high performance Motor, reducer and brake. Compact design, light weight, low energy consumption, low noise and eco-friendly design. Electromagnetic brake disc (Asbestos-free). Long Service life and easy maintenance.



OVERLOAD PROTECTION
Load Cell connected to a Limit Relay (Adjustable) to avoid overloading of the hoist.



WIRE ROPE GUIDE
Helps the winding of the rope on the drum. Light weight and highly resistance. Design to reduce friction on the wire rope and avoid premature wear.

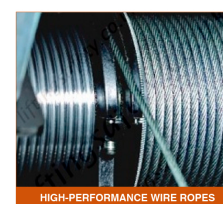

HIGH-PERFORMANCE WIRE ROPES
High-performance wire rope with tensile strength up to 2160Mpa. Galvanized surface and high flexibility to ensure long service life.



DRUM
Q345 steel, seamless grooved drum. Design to fulfill FEM and ASME standards and ensure a safe operation.



LIMIT SWITCHES
High precision adjustable height limit switches, for all movements of hoist and trolley.

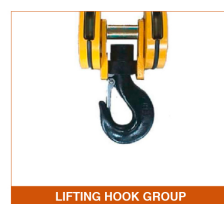

LIFTING HOOK GROUP
DIN standard lifting hook with safety clasp. Forged by the high-strength material of T grade.



CONTROL BOX
Electric Control box with Schneider Inverter, Eaton contactors and components. Compact design, easy access, IP65 Enclosure.

Peso & Dimensiones

H Altura Muerta	596 mm
A Altura Total	846 mm
Peso Total	1323 lbs / 601 Kg

Detalles del Empaque

Paquete 1 Peso Neto	1102 lbs / 500 Kg
Paquete 1 Ancho	62 in / 157.48 cm
Paquete 1 Peso Bruto	1323 lbs / 600 Kg
Paquete 1 Altura	59 in / 149.86 cm
Paquete 1 Profundidad	41 in / 104.14 cm

Referential Images / Imágenes Referenciales